



**Serie / Series**

**1800**

**RACCORDI E ACCESSORI  
CON ATTACCO A BAIONETTA**  
*FIXTURES AND FITTINGS  
WITH BAYONET CONNECTION*

## Caratteristiche Tecniche | Technical Characteristics

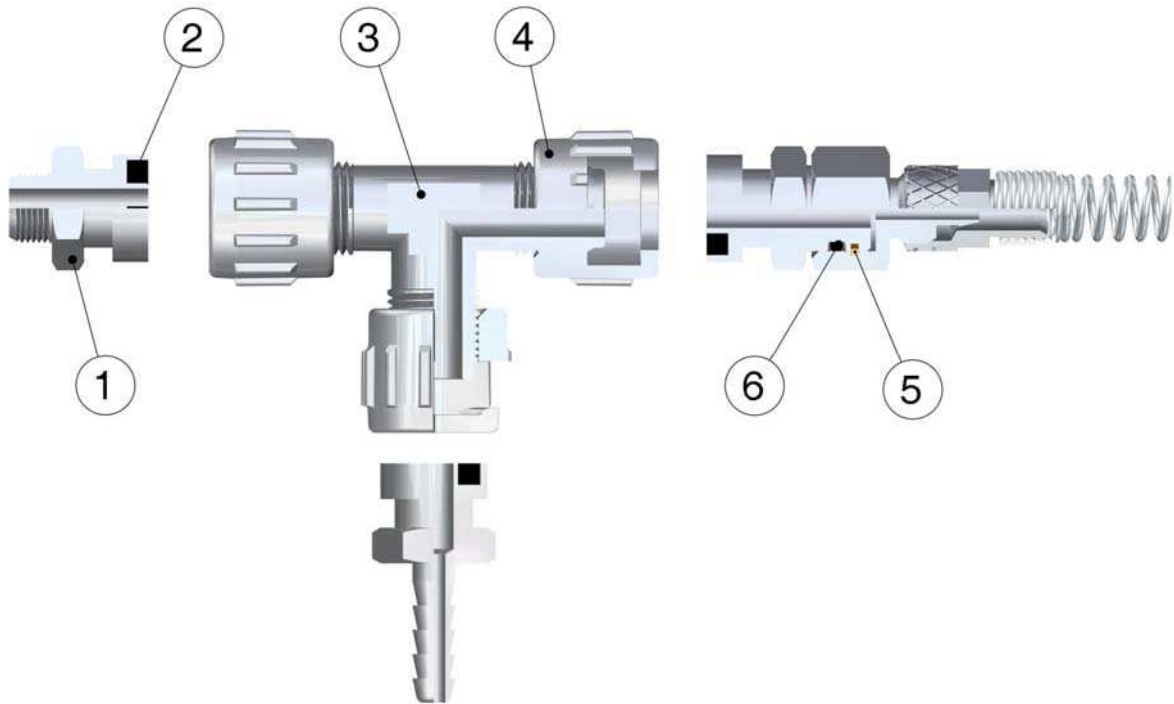

## Materiali e Componenti | Component Parts and Materials

- 1 Baionetta in Ottone Nichelato
- 2 Guarnizione in NBR 90
- 3 Corpo in ottone nichelato
- 4 Dado capettato in zama nichelato
- 5 Seeger in bronzo
- 6 Guarnizione o-ring in NBR 70

- 1 Nickel-plated brass Bayonet
- 2 NBR 90 Seals
- 3 Nickel-plated brass Body
- 4 Nickel-plated zamac Milled Nut
- 5 Bronze Seeger
- 6 NBR 70 o-ring seal

## Pressioni | Pressures

Pressioni e temperature sono determinate dal tipo di tubo impiegato, pertanto tali valori sono da definirsi in base alle caratteristiche del tubo stesso. I valori riguardano quindi esclusivamente i componenti da noi prodotti.

*The working pressure and working temperatures depend on which type of tube is used, for this reason, the values must be determined in accordance with the tube's features.*

Pressione minima / Minimum pressure: **-0.99 bar (-0.099 MPa)**

Pressione massima / Maximum pressure: **15 bar (1.5 MPa)**

## Filettature | Threads

Gas cilindrica conforme ISO 228 Classe A / Parallel gas in conformity with ISO 228 Class A.

Metrica conforme ISO R/262 / Metric in conformity with ISO R/262.

## Tubi di collegamento | Connection Tubes

Tubi in materiale plastico:

PA6, PA11, PA12, Polietilene, \*Poliuretano, PVC intrecciato.

Poliuretano intrecciato per l'articolo 1810

\*Per tubi in Poliuretano é consigliata una durezza di 98 shore.

Plastic tubes:

PA6, PA11, PA12, Polyethylene, \*Polyurethane, Braided PVC.

Braided polyurethane for Art. 1820

\*For Polyurethane hoses it is required a minimum hardness of 98 shore.

## Temperature | Temperatures

Temperatura minima / Minimum temperature: **-18 °C**

Temperatura massima / Maximum temperature: **+70 °C**

## Fluidi compatibili | Fluids

Aria compressa, fluidi e liquidi a bassa pressione compatibili con il tipo di accoppiamento.

*Compressed air, fluids and liquids at low pressure compatible with the connection.*

## COME ORDINARE

I raccordi e accessori standard con attacco a baionetta prevedono:

- Trattamento superficiale di NICHELATURA

Per formulare un ordine é sufficiente specificare ARTICOLO, MISURA, QUANTITA'.

## HOW TO ORDER

The standard fixtures and fittings with bayonet connection are supplied with:

- Surface treatment of NICKEL-PLATING

To order simply specify the ARTICLE CODE, SIZE and QUANTITY.

# 1830

MASCHIO A BAIONETTA - MALE BAYONET

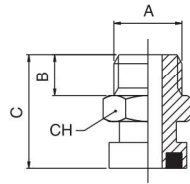

	A	B	C	CH	Conf. Pack.
<b>1/8</b>	6	19,5	15		25
<b>1/4</b>	8	22	15		25
<b>3/8</b>	9	23	19		25

1 8 3 0

1/4

CODICE ARTICOLO  
ARTICLE CODE

MISURA  
SIZE

# 1810

RACCORDI PER TUBI IN GOMMA - FITTING FOR RUBBER HOSE

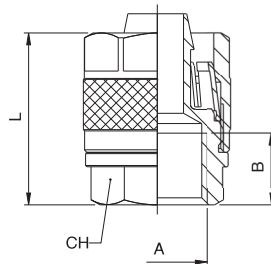
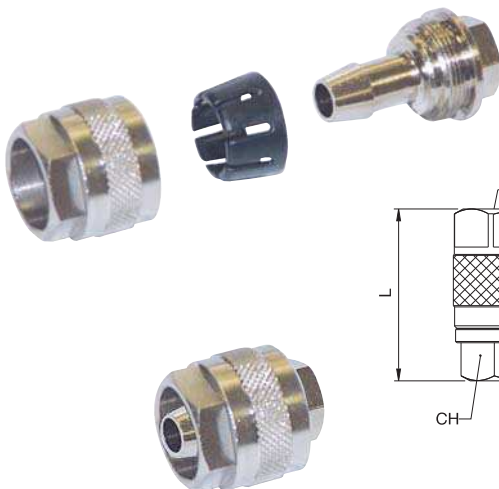

Tubo/Tube	A	B	L	CH	Conf. Pack.
<b>14/6</b>	1/4	11	30	16	25
<b>17/8</b>	1/4	11	31	16	25
<b>19/10</b>	1/4	11	31	17	25
<b>23/13</b>	1/2	17	36	24	25

RACCORDI PER TUBI  
IN POLIURETANO INTRECCIATO  
FITTINGS FOR BRAIDED  
POLYURETHANE HOSES

Tubo/Tube	A	B	L	CH	Conf. Pack.
<b>10/6</b>	1/4	11	30	15	25
<b>12/8</b>	1/4	11	31	16	25
<b>15/10</b>	1/4	11	31	17	25



# 1830

MASCHIO A BAIONETTA - MALE BAYONET

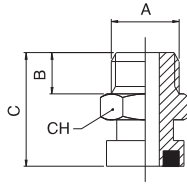

A	B	C	CH	Conf. Pack.
<b>1/8</b>	6	19,5	15	25
<b>1/4</b>	8	22	15	25
<b>3/8</b>	9	23	19	25

# 1831

FEMMINA A BAIONETTA - FEMALE BAYONET

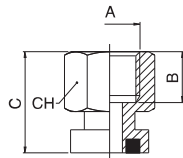

A	B	C	CH	Conf. Pack.
<b>1/8</b>	8,5	19,5	15	25
<b>1/4</b>	11	22	17	25
<b>3/8</b>	11	22	20	25

# 1832

BAIONETTA A RESCA - BAYONET WITH REST

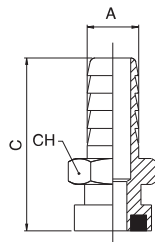

Tubo/Tube	A	C	CH	Conf. Pack.
<b>int. 6</b>	6	33,5	15	25
<b>int. 7</b>	7	33,5	15	25
<b>int. 8</b>	8	33,5	15	25
<b>int. 9</b>	9	33,5	15	25
<b>int. 10</b>	10	33,5	15	25
<b>int. 12</b>	12	33,5	15	25

# 1833

BAIONETTA PORTAGOMMA - BAYONET FOR RUBBER HOSE

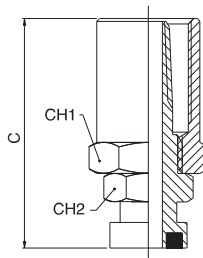

Tubo/Tube	CH1	CH2	C	Conf. Pack.
<b>est. 14 - int. 6</b>	17	15	44,5	25
<b>est. 17 - int. 8</b>	20	15	44,5	25
<b>est. 19 - int. 10</b>	22	15	44,5	25

# 1840

MASCHIO PORTAGOMMA - MALE FOR RUBBER HOSE

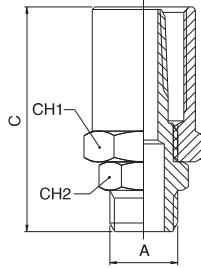

Tubo/Tube	A	CH1	CH2	C	Conf. Pack.
10/6 - 1/4	15	17	43	25	
12/8 - 1/4	15	17	43	25	
14/6 - 1/4	17	17	43	25	
15/10 - 1/4	18	17	43	25	
17/8 - 1/4	20	17	43	25	
17/8 - 3/8	20	19	44	25	
19/10 - 1/4	22	17	43	25	
19/10 - 3/8	22	19	44	25	

# 1841

FEMMINA PORTAGOMMA - FEMALE FOR RUBBER HOSE

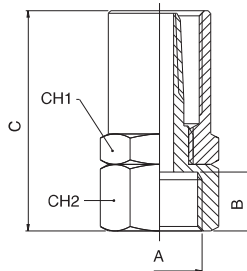

Tubo/Tube	A	B	C	CH1	CH2	Conf. Pack.
10/6 - 1/4	11	43	15	17	25	
12/8 - 1/4	11	43	15	17	25	
14/6 - 1/4	11	43	17	17	25	
15/10 - 1/4	11	43	18	17	25	
17/8 - 1/4	11	43	20	17	25	
17/8 - 3/8	11.5	43.5	20	20	25	
19/10 - 1/4	11	43	22	17	25	
19/10 - 3/8	11.5	43.5	22	20	25	

# 1855

RACCORDO DIRITTO CON ATTACCO A BAIONETTA + DADO CON MOLLA  
STRAIGHT FITTING WITH BAYONET CONNECTION + NUT AND SPRING

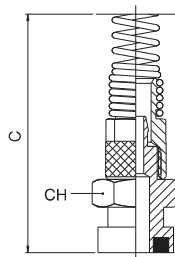

Tubo/Tube	CH	C	Conf. Pack.
6/4	15	110	25
8/6	15	115	25
10/8	15	123	25
12/10	16	130	25

# 1860

RACCORDO DIRITTO GIREVOLE CON ATTACCO A BAIONETTA + DADO CON MOLLA  
SWIVEL STRAIGHT FITTING WITH BAYONET CONNECTION + NUT AND SPRING

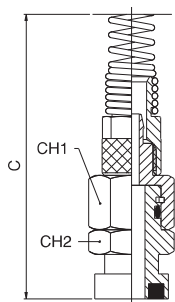
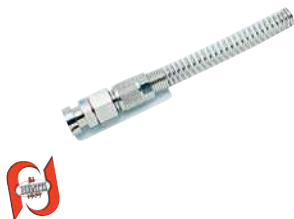

Tubo/Tube	CH1	CH2	C	Conf. Pack.
6/4	15	15	120	25
8/6	15	15	125	25
10/8	15	15	134	25
12/10	17	17	141	25

# 1850

MASCHIO CON DADO CAPETTATO - MALE WITH MILLED NUT

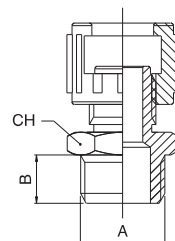

A	B	CH	Conf. Pack.
1/8	6	14	25
1/4	8	15	25
3/8	9	19	25

# 1851

FEMMINA CON DADO CAPETTATO - FEMALE WITH MILLED NUT

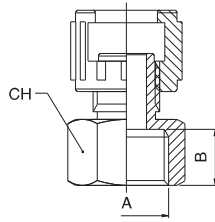

A	B	CH	Conf. Pack.
1/4	11	17	25
3/8	11	20	25

# 1852

DOPPIO DADO CAPETTATO - DOUBLE MILLED NUT

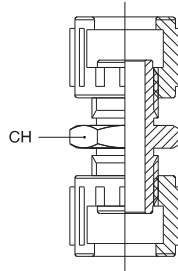

A	CH	Conf. Pack.
	15	25

# 1853

T CON DADI CAPETTATI - TEE WITH MILLED NUTS

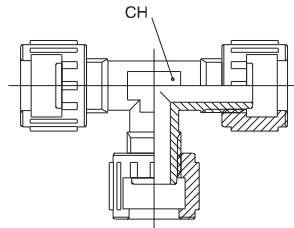

A	CH	Conf. Pack.
	13	25

# 1808

DADO CAPETTATO - MILLED NUT

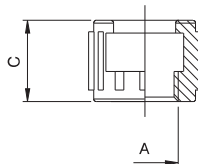

A	C	Conf. Pack.
1/4	16	25

# 1864

GUARNIZIONE DI TENUTA PER RACCORDI CON ATTACCO A BAIONETTA - TIGHTENING SEAL FOR FITTINGS WITH BAYONET CONNECTION

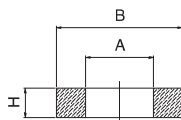

A	B	H	Conf. Pack.
7	13	3	50